

# MASTER PLAN

BELCHAMPA INDUSTRIAL AREA, GARWA  
JIADA (RANCHI REGION)

IN . ACRE

CATEGORY

- 1. TOTAL LAND AREA → 98.870 ACRE
- 2. ADMINISTRATIVE AREA → 0.50 ACRE
- 3. COMMON FACILITY AREA → 14.505 ACRE
- 4. NET INDUSTRIAL AREA → 83.865 ACRE
- 5. OTHER AREA → NIL

- HAZARDOUS / POLLUTING
- NON HAZARDOUS / NON POLLUTING
- MIXED - YES

A

B

C

D

## INTERNAL INFRASTRUCTURE

- POWER POLE / SUBSTATION - YES
- ICT - PROP
- STP - NO
- CETP - PROP
- WATER SUPPLY / WATER TREATMENT - PROP
- STORM WATER DRAINAGE / COVERED - OPENED - PROP
- RUN OFF USED FOR RAIN WATER HARVESTING - YES
- ROADS - YES

## EXTERNAL INFRASTRUCTURE

- LOGISTIC TERMINAL - 8 KM SS
- POWER SUB STATION - 3 KM NS
- SOLID WASTE DISPOSAL / TREATMENT SITE 6 KM
- BUS STOP - 0 KM
- RAIL - 3 KM NS
- PORTS - MAPPED WITH GIS
- AIR PORTS - 215 KM ES

## COMMON FACILITY

- COMMON FACILITY CENTER - PROP
- DORMITORY FOR LODGING - PROP
- BANK BRANCH / ATM - PROP
- CANTEEN / RESTORENT - PROP
- WEIGH BRIDGE FOR CARGO / FREIGHT - PROP
- TRUCK PARKING - NO
- SKILL DEVELOPMENT CENTER - PROP
- CFC - (ADMINISTRATION AREA, COMMON FACILITY AREA)

## SAFETY

- FIRE SAFETY PROP
- AIR QUALITY MONITRING STATION - PROP

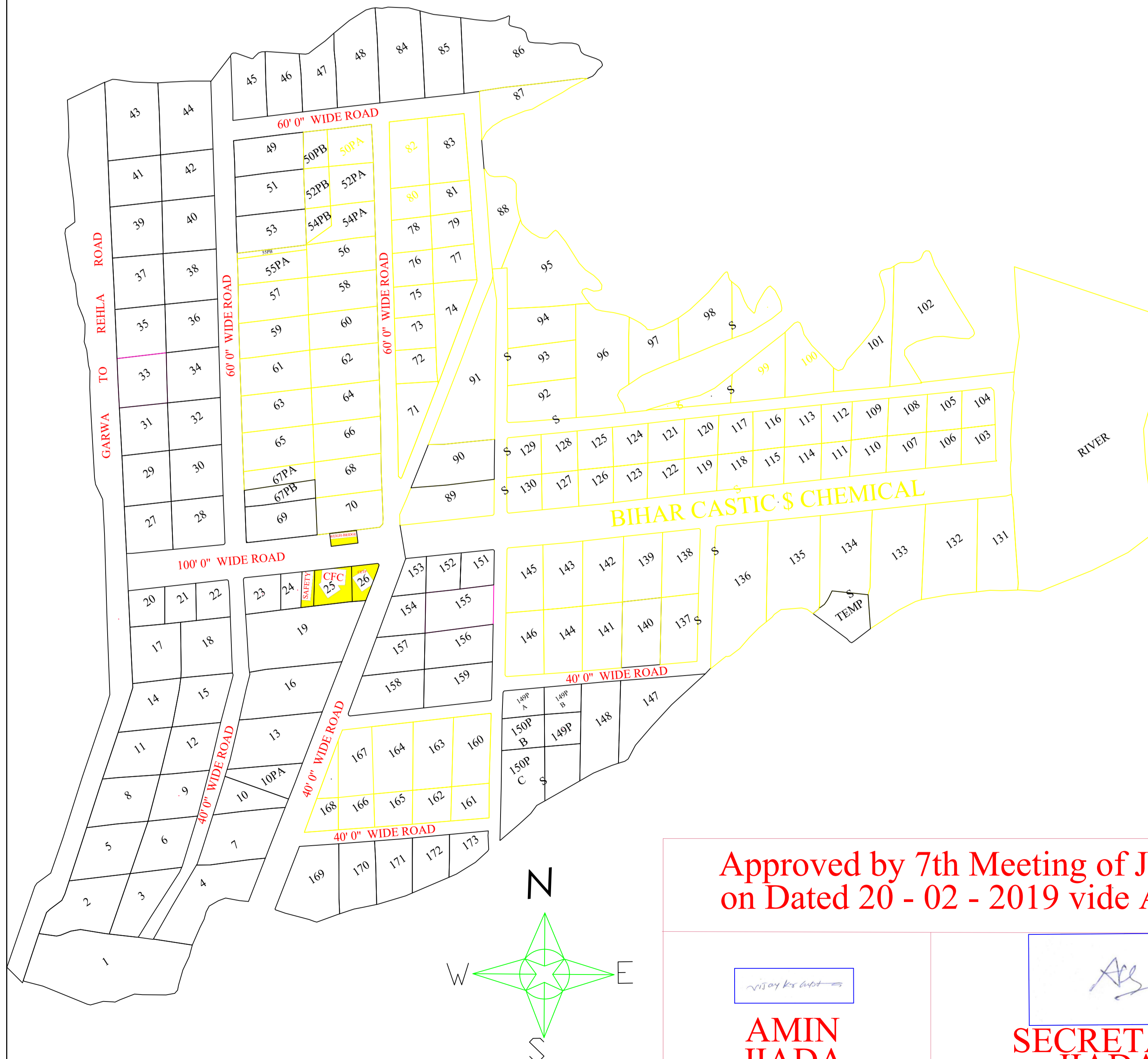

## LOCATION MAP.

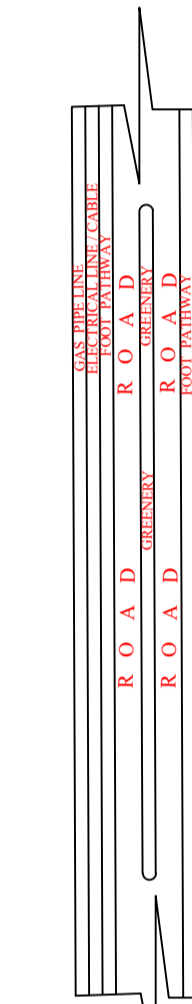
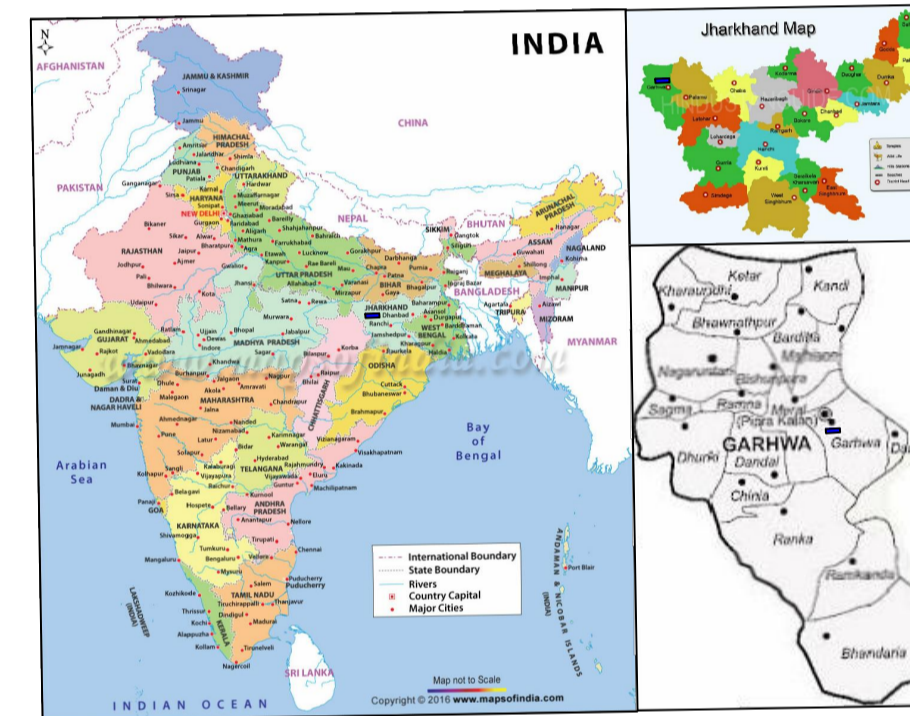

SPECIFICATION OF ROAD

NOTES :-

SEGMENT WISE DETAILS OF PLOT	PLOT SIZE
1. CHEMICAL / FERTILIZER	<input type="checkbox"/>
2. AUTOMOBILE	<input type="checkbox"/>
3. ELECTRONIC ITEM.	<input type="checkbox"/>
4. FOOD INDUSTRIES	<input type="checkbox"/>
5. GENRAL PLASTIC ITEM	<input type="checkbox"/>
6. TEXTILE INDUSTRES	<input type="checkbox"/>
7. WERE HOUSING AND LOGISTIC.	<input type="checkbox"/>
8. IT / COMPUTER INDUSTRES.	<input type="checkbox"/>
9. FABRICATION AND JOB WORK.	<input type="checkbox"/>
<b>PLOT STATUS.</b>	
1. ALLOTTED.	<input type="checkbox"/>
2. VACANT.	<input type="checkbox"/>
3. INPRODUCTION.	<input type="checkbox"/>

Approved by 7th Meeting of JIADA Board of Directors  
on Dated 20 - 02 - 2019 vide Agenda no - 07/JIADA - 02/2019

*[Signature]*

AMIN  
JIADA

*[Signature]*

SECRETARY  
JIADA

*[Signature]*

MD  
JIADA